

BEFORE & AFTER

CURB APPEAL!

MAKE YOUR HOME
THE BEST ON THE BLOCK

GET THE
HOME
YOU LOVE
OPEN
KITCHEN
COZY
FIREPLACE
SMART
BUILT-INS

START
TODAY
10 WEEKEND
PROJECTS
p. 6



**SIZE
MATTERS!**
BIG UPDATES
FOR SMALL
SPACES

2018
BHG.com

Display until May 21



BHG specials™



CAMOUFLAGE CHIC

*Make the most of an open plan:
Hide the kitchen in plain sight.*

1. REMOVE Replace upper cabinets with a wall of windows, artwork, open display shelving, or a beautiful backsplash. Make up for lost storage by using space in the pantry, dining room, basement, or garage.

2. DISGUISE Integrate the refrigerator and dishwasher into cabinetry, or push them into the butler's pantry. Hide the fridge inside an armoire or choose appliance drawers instead of full-size models.

3. KICK BACK Pull living room furniture into the space where you cook and eat. In this great room, the homeowner chose upholstered accent chairs for casual dining and table lamps hardwired to the island.

ABOVE The great-room's casual dining area hosts comfy chairs upholstered in wipe-clean fabric surrounding a square table designed by Fiorella. The kitchen island is illuminated by turquoise glass-base lamps wired to the island. Tucked into the wall next to stacked ovens, the white-painted office zone offers a mom-approved place for kids to do homework. **BELOW LEFT** Just off the foyer, a new powder room is elegantly appointed. The vanity wears a glossy gray finish, mirror-backed doors, and a rectangular vessel sink. **RIGHT** Staggered rows of 1x2-inch stainless-steel backsplash tiles add an industrial edge to the laundry room. **BEFORE** The laundry room's dark cabinets, laminate countertop, and vinyl flooring were all function, no flair.



BEFORE





LEFT Above the sculptural freestanding tub, Nielsen says, “the arched ceiling creates a Spanish grotto feel.” **BELOW** A shiny chrome finish on the vanity’s drawer and cabinet pulls and faucets pairs with a white quartzite countertop “to bring a touch of glamour into the master bathroom,” Nielsen says. Medicine cabinets flank the vanity for double the storage.



THE PLAN

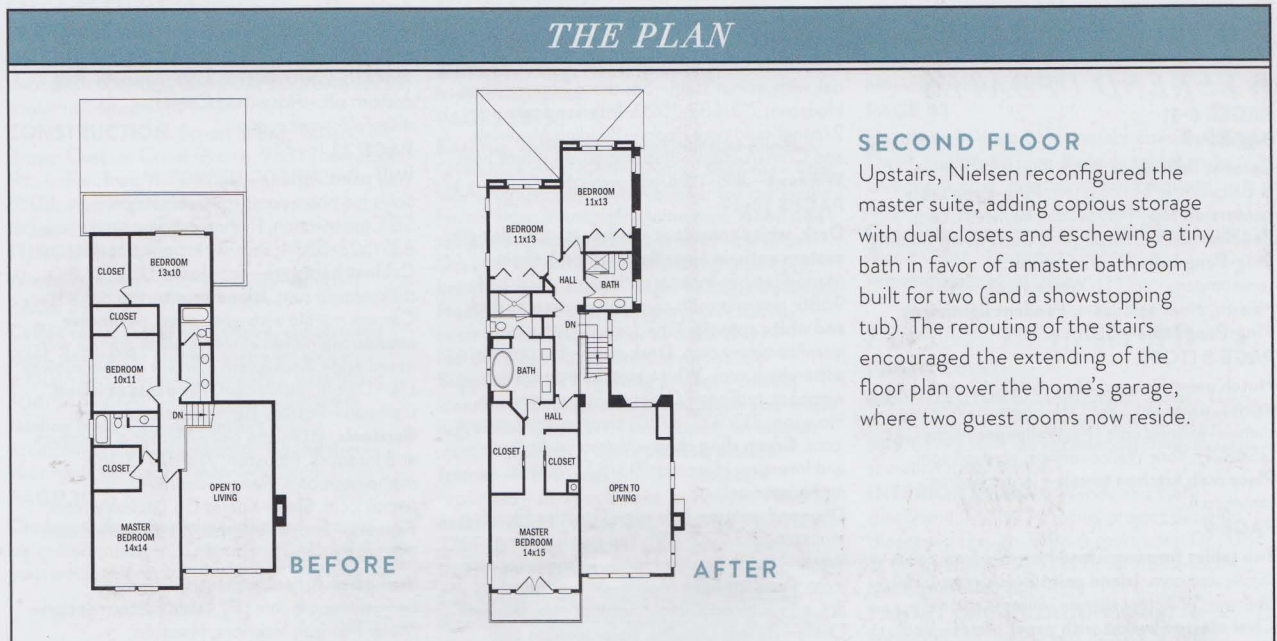

SECOND FLOOR

Upstairs, Nielsen reconfigured the master suite, adding copious storage with dual closets and eschewing a tiny bath in favor of a master bathroom built for two (and a showstopping tub). The rerouting of the stairs encouraged the extending of the floor plan over the home’s garage, where two guest rooms now reside.

DIVE IN WITH DETAILS

Take a closer look at how interior designer Brittney Nielsen added artful touches to give the Calhoun home a unique style.



1. MIXED-UP STOCK

Alternating stock mosaics creates a custom mix of color and shape on the master bathroom vanity backsplash.



2. SMALL TOUCH

Leather-wrapped pulls offer understated Spanish styling and a touch of personality.



3. HAND-CRAFTED

Leather flooring applied to risers and a hand-forged iron railing with a satin-black finish give presence and warmth to the staircase.



4. SUBTLY NAUTICAL

Aluminum strips mimic the look of a boat deck in the living room storage niches. The trick is repeated on the kitchen island.



5. PRIVATE MOMENT

An unusual sink brings Nielsen's signature "wow" to the powder room.



ABOVE "The master bedroom needed to feel quiet and secluded," Nielsen says, so she chose muted tones to provide an air of tranquility. Pendant fixtures flank the bed and free up nightstands for belongings. **BEFORE** A dated set of sliding doors was replaced with arched French doors and flanking windows.



katie@neatmethod.com; neatmethod.com.

CONSTRUCTION: Robert Myers, RS Myers Company, 30012 Ivy Glenn Dr., Suite 145, Laguna Niguel, CA 92677; 949/542-4000; rsmyerscompany.com.

LANDSCAPE ARCHITECTURE: David A. Pedersen, Newport Beach, CA; 949/251-8999; dlandscape.com.

PAGE 45

Stair runner—Masland Carpets; maslandcarpets.com. **Area rug**—Rug Resources; rugresources.com. **Chandelier** John Pomp—A. Rudin; arudin.com [T]. **Sculpture**—Corbin Bronze; corbinbronze.com.

PAGES 46–47 (BOTTOM)

Fireplate Pietra gray marble, leathered—Ollin Stone; ollinstone.com. **Sliding doors**—Western Window Systems; westernwindowssystems.com. **Club chairs**—A. Rudin; arudin.com [T]. **Fabric for chairs**—Kravet; kravet.com. **Coffee table**—Robert James Collection; robertjamescollection.com. **Table lamp**—Visual Comfort & Co.; visualcomfortlightinglights.com. **Console**—Made Goods; madegoods.com. **Fabric for drapery**—Hartmann & Forbes; hartmannforbes.com. **Area rug**—Saxony Carpet Co.; saxcarpet.com [T].

PAGE 47 (TOP)

Fabric for club chairs—Sunbrella; sunbrella.com. **Coffee table**—Janus et Cie; 800/245-2687; janusetcie.com. **Area rug**—Perennials Outdoor Fabrics; 888/322-4773; perennialsfabrics.com [T].

PAGE 48

Dining table—Robert James Collection; robertjamescollection.com. **Host chairs**—Lee Industries; leeindustries.com. Buffet Knowlton Brothers—Thomas Lavin; thomaslavin.com. **Mirror**—Restoration Hardware; restorationhardware.com. **Chandelier**—Arteriors Home; 877/488-8866; arteriorshome.com [T]. **Drapery fabric**—Hartmann & Forbes; hartmannforbes.com. **Area rug**—Cavan Carpets; cavan carpets.com.

PAGE 49

Cabinet hardware—Rocky Mountain Hardware; rockymountainhardware.com. **Countertops, backsplash** Calacatta Eccellente—Ollin Stone; ollinstone.com. **Hood and island accent tile**—Artistic Tile; artisticstile.com. **Range**—Wolf Appliances; wolfappliances.com. **Coffee system**—Miele; mieleusa.com. **Sink**—Julien; julien.ca. **Faucets**—Waterstone Co.; waterstoneco.com. **Dog dish filler faucet**—Hansgrohe; hansgrohe-usa.com. **Pendant lighting**—Regina Andrew Design; reginaandrew.com. **Counter stools**—Powell & Bonnell; powellandbonnell.com. **Fabric for stools**—Perennials Outdoor Fabrics; perennialsfabrics.com [T].

PAGES 50–51

Cabinet hardware—Rocky Mountain Hardware; rockymountainhardware.com. **Cabinet paint** Hale Navy—Benjamin Moore; benjaminmoore.com [P]. **Countertops** Calacatta Eccellente—Ollin Stone; ollinstone.com. **Flooring** Tabarka Studio—Ann Sacks; annsacks.com. **Backsplash**—Walker Zanger; walkerzanger.com. **Sink**—Julien; julien.ca. **Faucets**—Waterstone Co.; waterstoneco.com. **Baskets and organization**—Katie Koentje, Neat Method, San Diego; 858/952-9850; katie@neatmethod.com; neatmethod.com.

PAGE 52

Flooring insert—Walker Zanger; walkerzanger.com. **Countertops, backsplash, shower** Statuario marble—Ollin Stone; ollinstone.com. **Tub**—BainUltra; bainultra.com. **Mirrors**—

Electric Mirror; electricmirror.com. **Cabinet hardware**—Amerock Corp.; amerock.com. **Ceiling fixture**—Visual Comfort & Co.; visualcomfortlightinglights.com. **Ottoman**—Kelly Wearstler; kellywearstler.com.

PAGE 53

Countertop at television Statuario marble—Ollin Stone; ollinstone.com. **Wallpaper in built-in cabinetry**—Phillip Jeffries Ltd.; phillipjeffries.com. **Cabinet hardware**—Amerock Corp.; amerock.com. **Wall treatment in bed nook**—Casamance; casamance.com. **Table lamps**—Arteriors Home; arteriorshome.com [T]. **Bedding**—Pinecone Hill, an Annie Selke company; annieselke.com. **Drapery fabric** Castel Maison—Donghia; donghia.com [T]. **Area rug**—Antrim Carpets, USA; antrimcarpet.com. **Paint for wall, trim, and ceilings** Simply White—Benjamin Moore; benjaminmoore.com [P]. **Vintage wood beams**—Wood Concepts; wood-concepts.com.

COTTAGE 2.0

PAGES 54–57

EXTERIOR DESIGN: Hillary Blazin Rondero, Hill Rondero Design, Charlotte; 704/962-0951; hill@hillrondero.com; hillrondero.com.

CONSTRUCTION: David DuBose, DuBose Custom Homes, P.O. Box 37355, Charlotte, NC 28237; 704/348-7003; dubosebuilders.com.

LANDSCAPE COLLABORATION AND INSTALLATION: Hugh Crump, Greenline Design, P.O. Box 667483, Charlotte, NC 28266; 704/392-5433; greenlinedesign.net.

Lanterns—Carolina Lanterns & Lighting; carolin lanterns.com. **Concrete paving**—Greenline Design, Charlotte; 704/392-5433; greenlinedesign.net. **Doors, windows**—Monarch Windows and Doors; monarchwindows.com. **Large white pots**—West Elm; westelm.com. **Metal car**—The Land of Nod; landofnod.com. **Pillows**—Target Stores; target.com. **Plants**—Lowe's; lowes.com.

CAPITAL IMPROVEMENTS

PAGES 58–65

INTERIOR DESIGN: Kiera Kushlan, Residents Understood, Washington, D.C.; info@residentsunderstood.com; residentsunderstood.com.

PAGES 58–59

Table—IKEA; ikea.com. **Chairs**—Overstock.com; overstock.com. **Fabric for striped bench**—Perennials Outdoor Fabrics; perennialsfabrics.com [T]. **Chandelier**—Anthropologie; anthropologie.com. **Mirror**—Restoration Hardware; restorationhardware.com.

PAGE 60 (LEFT)

Runner—Dash & Albert, an Annie Selke company; annieselke.com. **Ceiling light**—Schoolhouse Electric; schoolhouseelectric.com.

PAGES 60 (RIGHT)–61

Sofa—Room & Board; roomandboard.com. **Coffee table**—Pottery Barn; potterybarn.com. **Leather chairs**—Dwell; dwellstudio.com.

PAGES 62–63

Cabinetry—KraftMaid; kraftmaid.com. **Cabinet hardware**—Restoration Hardware; restorationhardware.com. **Range hood**—KitchenAid; kitchenaid.com. **Range, refrigerator** Monogram—GE Appliances; geappliances.com. **Faucet**—Wayfair; wayfair.com.

Sink—Kohler Co.; us.kohler.com. **Stainless-steel island**—Amazon; amazon.com, search: stainless steel island.

PAGE 64

Crib—The Land of Nod; landofnod.com. **Bookcase**—West Elm; westelm.com. **Chair**—IKEA; ikea.com. **Ottoman**—Etsy; etsy.com, search: Moroccan ottoman. **Sofa**—Restoration Hardware; restorationhardware.com. **Rug**—Dash & Albert, an Annie Selke company; annieselke.com. **Ceiling paint** High Park—Benjamin Moore; benjaminmoore.com [P].

PAGE 65

Bed—Wayfair; wayfair.com. **Bedsides tables, lamps**—Target Stores; target.com. **Roman shade**—The Shade Store; theshadestore.com. **Dots on walls decals**—Etsy; etsy.com, search: dot wall decals. **Rug**—Schoolhouse Electric; schoolhouseelectric.com.

CAREFULLY CURATED

PAGES 66–75

INTERIOR DESIGN: Beth Bourque, Beth Bourque Design Studio, 75 Adams St., Suite A, Milton, MA 02186; 617/696-2824; beth@bethbourquedesign.com; bethbourquedesign.com.

CONSTRUCTION: Paul Piotrowicz, TRAM Construction, Holbrook, Massachusetts; 781/696-3495; tramconstruction.com.

Barn door hardware—Artisan Hardware; artisanhardware.com. **Barn door paint** Twilight—Benjamin Moore; benjaminmoore.com [P].

Cabinetry Greenfield Cabinet Co.—through Bay State Kitchen Design, Concord, MA; 781/941-2340; baystatekitchendesign.com.

Black kitchen sink—Franke; franke.com.

Faucets—Newport Brass; newportbrass.com.

Refrigerator—Electrolux Home Products;

electroluxappliances.com. **Dishwasher, range**—Thermador; thermador.com. **Ceiling fixtures**—Etsy; etsy.com, search: ceiling lights. **Barstools**—Pier 1 Imports; pier1.com.

Floor tile Vivacu Gray—Tiles By Perfection, Quincy, MA; 617/479-4944;

tilesbyperfection.com. **Wood shelving**—Longleaf Lumber; longleaflumber.com. **Blue tea kettle**—Le Creuset of America; lecreuset.com.

Dining table—Steve Staples, Creative Art Furniture; staplescabinetmakers.com. **Chairs** Tabouet **Bistro chair**—Overstock.com;

overstock.com. **Dining table**—Steve Staples, Creative Art Furniture; staplescabinetmakers.com. **Chairs** Tabouet **Bistro chair**—Overstock.com; overstock.com. **Flower arrangement on table**—Green Cottage; thegreencottage.com.

Vases on table and counter—IKEA; ikea.com.

MAKING SPACE

PAGES 76–83

ARCHITECTURE: William Wood, William Wood Architects, 301 Hartz Ave., Suite 203, Danville, CA 94526; 925/820-8233.

INTERIOR DESIGN: Mary Jo Fiorella, Fiorella Design LLC, 2811 Castro Valley Blvd., Suite 209, Castro Valley, CA 94546; 510/317-7300; maryjo@fiorelladesign.com; fiorelladesign.com.

CONSTRUCTION: R&J Construction, 2880 Camino Tassajara, Danville, CA 94506; 925/648-7942; r-jconstruction.com.

LANDSCAPE DESIGN: Peter Koenig Designs, 1451 Danville Blvd., Suite 108, Alamo, CA 94507; 925/743-9509; pkd.smugmug.com/Peter-Koenig-Designs.

THROUGHOUT

Doors—TruStile Doors; 888/286-3931; trustile.com. **Windows**—Sierra Pacific Windows; 800/824-7744; sierrapacificwindows.com. **Flooring** rift cut white oak with custom finish—California Wood Floors; californiawoodfloors.com. **PAGE 77**

Entry door hardware Zeus—Emtek Products; 800/356-2741; emtek.com. **Pendant lighting inside entry**—Visual Comfort & Co.; visualcomfortlightinglights.com. **PAGE 78**

Fireplace Flint Hills Gray Mottled Thin Veneer Belt Saw honed hearth material—US Stone Industries; usstoneindustries.com. **Cabinetry** custom design—Fiorella Design LLC, Castro Valley, CA; 510/317-7300; maryjo@fiorelladesign.com; fiorelladesign.com. **Cabinet fabrication**—Greg Jones, Jones Construction Group, Meadow Vista, CA; 530/878-3771. **Chandelier** Darlana—Visual Comfort & Co.; visualcomfortlightinglights.com. **Sectional sofa** Carson, **cocktail table** Broadway Square—Mitchell Gold + Bob Williams; mgandbw.com. **PAGE 79**

Fabric for chair seats and back inside Vintage Velvet Peacock—Pollack; pollackassociates.com [T]. **Fabric back outside** Seafield Cerulean Blue—Lee Jofa; 800/453-3563; leejofa.com [T]. **Chandelier** Zanadoo—Arteriors Home; 877/488-8866; arteriorshome.com [T]. **Paneling, trimwork** custom—through Fiorella Design LLC, Castro Valley, CA; 510/317-7300; maryjo@fiorelladesign.com; fiorelladesign.com. **Wallpaper** Nave 002—Trove; troveline.com. **Vases**—West Elm; 866/428-6468; westelm.com. **PAGES 80-81 (TOP)**

Island countertop Lagos Blue—CaesarStone US; 877/978-2789; caesarstoneus.com. **Exterior entry and back patio, cabinetry, table** Moments—custom design by Mary Jo Fiorella, Fiorella Design LLC, Castro Valley, CA; 510/317-7300; maryjo@fiorelladesign.com; fiorelladesign.com. **Cabinetry fabrication**—Greg Jones, Jones Construction Group, Meadow Vista, CA; 530/878-3771. **Cabinet hardware** Jeffrey Alexander—Kitchen Source; kitchensource.com. **Sink**—Julien; 800/461-3377; julien.ca. **Faucets**—Rohl; 800/777-9762; rohlhome.com. **Cooktop, vent**—Gaggenau; 800/828-9165; gaggenau-usa.com. **Chandelier** Poehlman—llex Architectural Lighting; llexlight.com. **Chairs**—Grandin Road; grandinroad.com. **Table lamps** Wilhelmina lamp, similar available—Arteriors Home; arteriorshome.com [T]. **PAGE 81 (BOTTOM LEFT)**

Vanity Harbor Gray Gloss—The Furniture Guild; thefurnitureguild.com [T]. **Faucet** Axor—Grohe America; groheamerica.com. **Mirror**—West Elm; westelm.com. **Pendant light** Venus—Worlds Away; worlds-away.com. **Wallpaper** Manilla Hemp in silver blue—Phillip Jeffries Ltd.; phillipjeffries.com. **PAGE 81 (BOTTOM RIGHT)**

Tile stainless steel—Ann Sacks; annsacks.com. **Cabinet hardware** Jeffrey Alexander—Kitchen Source; kitchensource.com. **PAGE 82**

Floor tile Miles Modular in white gloss, **wall tile** Bianco Dolomiti, polished—Artistic Tile; 877/237-4097; artistictile.com. **Cabinet hardware** Sutton in polished chrome by Jeffrey Alexander—Kitchen Source; kitchensource.com. **Pendants flanking vanity** Sara—Tech Lighting;

techlighting.com. **Towel bars** Ashbury—Restoration Hardware; restorationhardware.com. **Showerhead** Cascade—Artos; artos-westover.com. **Tub**—Wet Style; wetstyle.ca. **Drum pendant over tub** Worlds Away, **lamps flanking bed**—through Fiorella Design LLC, Castro Valley, CA; 510/317-7300; maryjo@fiorelladesign.com; fiorelladesign.com. **Bed and bedside tables**—Restoration Hardware; restorationhardware.com. **Chandelier** Jada—Arteriors Home; arteriorshome.com [T]. **Carpeting** Times Square in twill by Moda Carpet—Empire Today; empiretoday.com. **PAGE 83**

Stone fireplace—US Stone Industries; usstoneindustries.com. **Grill**—Weber—Stephen Products Co.; weber.com.

A SHORE WINNER

PAGES 84-91

ARCHITECTURE: Kevin Rugee, Kevin Rugee Architect, 1024 Isabella Ave., Coronado, CA 92118; 619/522-9504; architectrugee.com.

DESIGN: Brittney Nielsen, Brittney Nielsen Interior Design, P.O. Box 28355, San Diego, CA 92198; 858/213-5900; brittneynielsen.com.

CONSTRUCTION AND CABINETRY: Joe Palermo, Kitchen Worx, San Marcos, CA; 760/213-0137.

PAGES 84-85, 87

Cabinetry—Kitchen Worx, San Marcos, CA; 760/213-0137. **Cabinet pulls** Zanzibar—Atlas Homewares; atlashomewares.com. **Fireplace tile** from the Ever series with Moon Brick accent—Daltile; daltile.com. **Sectional sofa** Century—Great House Furniture; greathouse.com. **Plaid chair** Talia Swivel chair in Home Sand fabric—Crate & Barrel; crateandbarrel.com. **Cocktail table** Mosaic Petrified Wood coffee table—Palacek; palacek.com. **Console table** Ellsworth with stone top, **end table between sofa and chair** Huntington Round end table—Bernhardt Furniture Co.; bernhardt.com. **Stools at console** Modesto benches, similar items available—Sunpan Modern Home; sunpan.com. **Lamp** Tower table lamp in gunmetal—Jamie Young; jamieryoung.com. **Fabric for blue pillows** Bloom Embroidery in slate and indigo, **fabric for light pillows** Currents in silk slate—Lee Jofa; 800/453-3563; leejofa.com [T]. **Fabric for dark stipe pillows** Riviera Stripe—Robert Allen@Home; robertallendesign.com [T].

Rug from the Zuri collection—Jaipur Living; jaipurliving.com. **Drapery fabric** Nepal Pebble—Pindler & Pindler; pindler.com. **Pendant lantern at entry** Fergus—Currey & Co., Atlanta; curreyandcompany.com. **Flooring** Provence Marseille white oak—Reward Flooring; rewardflooring.com. **Wall paint** Worldly Gray SW7043—Sherwin-Williams; sherwin-williams.com [P]. **PAGE 86**

Tile flooring Cluny—Granada Tile; granadatile.com. **Sconce lighting at garage door** Chesterfield—Hinkley Lighting; hinkleylighting.com. **Stucco** Eggshell—Expo Stucco; expostucco.com. **PAGE 88**

Cabinetry—Kitchen Worx, San Marcos, CA; 760/213-0137. **Cabinet hardware** Blackrock—Amerock Corp.; amerock.com. **Island countertops** Superwhite Quartzite—

Amazon Stones; amazonstones.com. **Range area countertops** from the Silestone Nebula series in Lagoon—Cosentino USA; silestoneusa.com. **Backsplash tile** Manhattan Glass—Bedrosians; bedrosians.com. **Range**—Wolf Appliances; wolfappliances.com. **Refrigerator**—Jenn-Air; jennair.com. **Faucet** Arbor Motionsense High Arc—Moen; moen.com. **Pendant lighting** Euro Engles Pendant by Possini—Lamps Plus; 800/782-1967; lampsplus.com. **Barstools** Henson Counter stools—Arteriors Home; arteriorshome.com [T]. **PAGE 89 (LEFT)**

Chairs San Diego—Sunpan Modern Home; sunpan.com. **Table** Halton—Arteriors Home; arteriorshome.com [T]. **Pendant Affinity** 5 Light pendant by Varaluz—Ylighting LLC; ylighting.com. **Beverage refrigerator**—Perlick Corporation; perlick.com. **PAGE 89 (RIGHT)**

Sink cabinet material Antique Walrus from the Echelon collection—Eco Domo; ecodomo.com. **Countertop** Lagos Azul—CaesarStone US; caesarstoneus.com. **Cabinet hardware** Blackrock—Amerock Corp.; amerock.com. **Sink** Tiffany sink with Wave drain cover—Linkasink; linkasink.com. **Faucet** Opera single-handle wall faucet in brushed nickel—Artos; artos-westover.com. **Wall field tile** Lycian White limestone—Amazon Stones; amazonstones.com. **Backsplash tile** Mini Stack Polished Hampton—Arizona Tile & Stone; arizonatile.com. **Sconces** Piccolo—Sonneman; sonnemanlighting.com. **PAGE 90**

Bed Jefferson—Kravet; kravet.com. **Bedside chest** Artisan—Caracole; caracole.com. **Pendant lights flanking bed** Fairwater Large—Currey & Co., Atlanta; curreyandcompany.com. **Drapery fabric** 9929-1—Kravet; kravet.com. **White duvet cover and white pillow shams** Verana Linen in natural, **brown coverlet and shams** Interlaken in fossil—Pine Cone Hill, an Annie Selke company; annieselke.com. **Fabric for accent pillow** Kamala Mist—Kravet; kravet.com. **Rug** Lynx in gray—Crate & Barrel; crateandbarrel.com. **Wall paint** Worldly Gray SW7043—Sherwin-Williams; sherwin-williams.com [P]. **PAGE 91**

Wall tile Shimmer glass mosaic—Arizona Tile & Stone; arizonatile.com. **Countertops** Superwhite Quartzite—Amazon Stones; amazonstones.com. **Cabinet pulls** Brass Geometric in satin nickel—Emtek Products; emtek.com. **Sconces flanking tub and vanity** P1140-613-L—George Kovaks Lighting, a division of the Minka Group; minkagroup.net. **Sinks** Muse undermount—Icera Home & Bath; icerausa.com. **Tub** Barcelona—Victoria & Albert; vandabaths.com/usa. **Tub filler** Laminar—Kohler Co.; us.kohler.com. **Floor tile** Sparks Smokey Glimmer—Daltile; daltile.com. **Wall paint** Worldly Gray SW7043—Sherwin-Williams; sherwin-williams.com [P].