

# KITCHEN

## AND BATH IDEAS

**Amazing  
Small Bath**  
Just 63 square feet!  
p.44

# Best Small Kitchens Ever!

## 74 TIPS TO MAXIMIZE YOUR SPACE:

- Efficient floor plans
- Storage solutions
- Smart appliance picks

**Guide to store-all refrigerators p. 28**

December 2010  
Display until December 14





## small bath



**LEFT:** Glass mosaic tile, limestone tile, and clean-lined walnut cabinetry add up to a polished look that blends traditional and contemporary elements.

The homeowners' tastes run toward contemporary, but their grand old house is traditional.

To blend the two styles, Clendenon chose a neutral palette featuring 18×18-inch limestone tile with subtle variations. "Sometimes neutrals get a bad rap, but this room looks rich, and it has a lot of personality," Clendenon says. Glass mosaic tile accents, clean-lined cabinetry, and a rough-edged sink give a nod to modern aesthetics, while coppery fixtures and dark-stained wood pay tribute to tradition.

The makeover was mostly skin-deep, but a few reconstructive tweaks improved both the look and the layout of the 9×7-foot room. When cast-iron pipes in a wall stymied plans for a new wall-hung lavatory faucet, Clendenon turned the hiccup into an opportunity: She brought the wall behind the vanity 6 inches forward to create space for the plumbing valves—and set the stage for a glass mosaic backdrop. "The jog in the wall is a natural termination point for the glass tile," Clendenon says. "Without the jog, the mosaic wouldn't have looked right. I would've continued the limestone across the entire wall."

To boost function and style, Clendenon traded a linen closet for a built-in cabinet. The cabinet's drawers are more convenient than shelves alone, she notes. Another tweak: Carpenters adjusted the framing in the wall behind the tub to accommodate a trio of storage niches. "It's a simple change if you're stripping the wall anyway," says Clendenon, who also had the wall plumbed for a separate handheld shower.

## FIT FOR COMPANY

This elegant space serves as both a powder room for guests and a full bath for a busy family.

written by **ANDRIA HAYDAY**  
photographer **ANTHONY-MASTERSON**  
field editor **LISA MOWRY**  
photo stylist **LYNN NESMITH**

### LOTS OF THINGS CAN BE PRETTY IN PINK.

A dated bathroom with tile in cotton-candy hues is not one of them. The owners of this Pensacola, Florida, home were "really, really tired of all that pink," says designer Cheryl Kees Clendenon, who gave the space a sophisticated makeover.

As the only main-level bath in a century-old home, its primary role is as a powder room for guests. But with three teenagers in the family and upstairs bathrooms in short supply, it also needs to serve as a family bath—and the nightly soaking retreat of one daughter. Another design challenge:

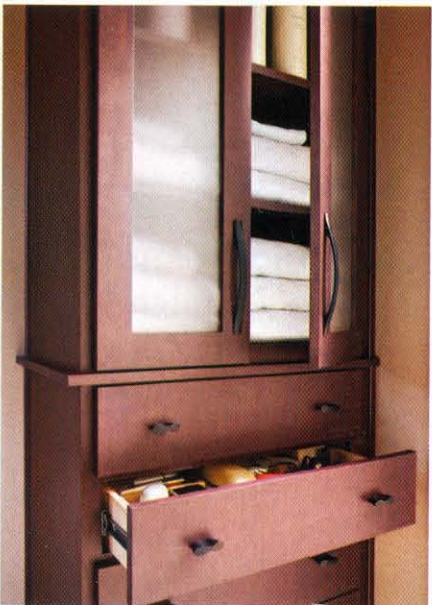
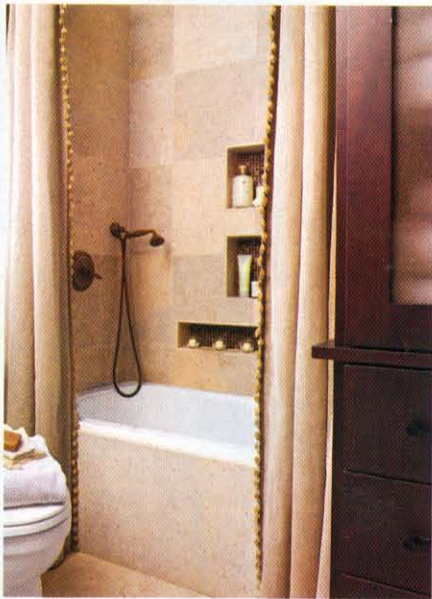

For the perfect finishing touch, the designer commissioned a luxe shower curtain that complements the tilework. "I've never been a big fan of glass doors on tubs," she says. "They're uncomfortable when you're soaking in the tub." Edged with beading and split in two panels, the curtain hangs from a rod that neatly aligns with the adjacent window frame. "A shower curtain is a huge canvas, especially in a small space," Clendenon says. "If you're spending money to redo your bathroom, it's worth the impact to have a shower curtain designed to complement the space." **KBI**

**ABOVE:** Clad in shimmering glass mosaic tile, a shallow "bump-in" provides a dramatic backdrop for the vanity. **TOP LEFT:** Limestone tile continues up the base of the tub. A double rod holds the custom shower curtain. **MIDDLE LEFT:** The built-in linen cabinet features resin panels with a subtle shimmer to obscure the contents in the upper portion. **BOTTOM LEFT:** A rough-edged vessel sink and a polished countertop, both in black granite, contrast with the coppery tones in the faucet and tile.

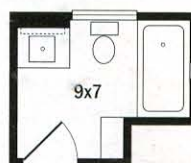

RESOURCES BEGIN ON PAGE 132.



#### 44-45 Fit for Company

**Designers**—Cheryl Kees Clendenon, Laura Cathings Lawrence, CKD, In Detail Kitchen & Bath, NKBA, NARI, 850/437-0636, [indetailkitchenandbath.com](http://indetailkitchenandbath.com).

**Tub** Basa—BainUltra, 800/463-2187, [bainultra.com](http://bainultra.com). **Shower, sink fixtures** in weathered copper—California Faucets, 800/822-8855, [calfaucets.com](http://calfaucets.com). **Sinks** Zen in black—Stone Forest, 888/682-2987, [stoneforest.com](http://stoneforest.com). **Toilet** Clayton—Toto USA, Inc., 800/350-8686, [totousa.com](http://totousa.com). **Cabinetry** custom, **countertops** granite in Absolute Black, **window treatment, shower curtain**—In Detail Kitchen & Bath, NKBA, NARI, 850/437-0636, [indetailkitchenandbath.com](http://indetailkitchenandbath.com). **Flooring, shower walls** limestone—Moza Tile, 850/437-9090, [mozatile.com](http://mozatile.com). **Lighting: sconce**—Hubbardton Forge, 802/468-3090, [vtforge.com](http://vtforge.com); **pendant**—Urban Objects, 850/912-8683.



#### 54-59 Love at Last

**Architectural design**—Watermark Coastal Homes, LLC, 843/379-3222. **Cabinetry** custom maple in Latte, wine cabinet and range hood in Coffee Bean—Wilmington Cabinet Co., 912/239-9914.

**Cabinetry hardware**—Top Knobs USA, Inc., 800/499-9095, [topknobsusa.com](http://topknobsusa.com).

**Countertops** granite in St. Cecilia; **backsplash decorative border** travertine—check with a local supplier. **Backsplash field tile** Venezia in Classico Antique, **decorative tile** Cote d'Or in Melange Rouge—Walker Zanger, 877/611-0199, [walkerzanger.com](http://walkerzanger.com). **Sink**—Blanco America, Inc., 800/451-5782, [blancoamerica.com](http://blancoamerica.com). **Floor rug, dining chandelier**—Past & Presents, 901/853-6454, [pastandpresentsonline.com](http://pastandpresentsonline.com). **Lighting: pendants over counter**—The Light Post, 843/815-8080, [thelightpost.com](http://thelightpost.com); **table lamps, brackets**—M Design, 843/524-7465. **Paint: walls** Believable Buff, **ceiling** Dover White—The Sherwin-Williams Co., 800/474-3794, [sherwin-williams.com](http://sherwin-williams.com) [P].

**Counter chairs, clock**—Ballard Designs, 800/367-2775, [ballarddesigns.com](http://ballarddesigns.com). **Dining table cloth** custom in Burlap—GDC Home Interiors, 843/849-0711, [gdchome.com](http://gdchome.com). **Chairs**—Haverty's, 843/837-5500, [havertys.com](http://havertys.com). **Slipcover fabric**—Rogers & Goffigan Ltd., 203/532-8068 [T].

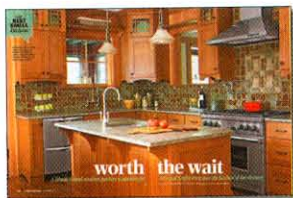

#### 60-65 Worth the Wait

**Architects**—Barbara J. Thornton, AIA, Mary Dorsey Brewster, AIA, Brewster Thornton Group Architects LLP, 401/861-1600, [brewstertornton.com](http://brewstertornton.com).

**Builder/contractor**—Doug Brownlow, Brownlow Assoc., Inc., 401/247-2255, [brownlowassociates.com](http://brownlowassociates.com). **Interior design**—Tricia Hogue, Jessie Dell, Scarborough-Phillips Design, Inc., 401/615-7761, [scarboroughphillips.com](http://scarboroughphillips.com). **Range**—Wolf Appliance, Inc., 800/332-9513, [wolfappliance.com](http://wolfappliance.com). **Vent hood**—Thermador, 800/735-4328, [thermador.com](http://thermador.com). **Refrigerator**—Sub-Zero, Inc., 800/222-7820, [subzero.com](http://subzero.com). **Dishwasher drawers**—Fisher & Paykel Appliances, Inc., 888/936-7872, [us.fisherpaykel.com](http://us.fisherpaykel.com). **Cabinetry** Design Group 42 with Chatham doors in cherry with custom glaze and stain—Wood-Mode, Inc., 877/635-7500, [wood-mode.com](http://wood-mode.com). **Drawer pulls**—Restoration Hardware, 800/910-9836, [restorationhardware.com](http://restorationhardware.com).

**Countertops** granite—check with a local supplier. **Backsplash tile**—Trikeenan Tileworks, 603/355-2961, [trikeenan.com](http://trikeenan.com). **Sinks: main**—Whitehaus Collection, 800/527-6690, [whitehauscollection.com](http://whitehauscollection.com); **island**—Franke Kitchen Systems Division; 800/626-5771; [franekesd.com](http://franekesd.com). **Faucets** Perrin & Rowe—Rohl, 800/777-9762, [rohlhome.com](http://rohlhome.com). **Flooring** Red Oak—check with a local supplier. **Windows**—Loewen Windows, 800/563-9367, [loewen.com](http://loewen.com). **Fruit stand**—Crate & Barrel, 800/967-6696, [crateandbarrel.com](http://crateandbarrel.com). **Lined basket**—Wish Basket, 978/465-1515.

For the best service,  
selection and value,  
go to the source...  
**BRANDSOURCE.**



**BRANDSOURCE®** has everything you need to make your house a home: Top name Appliances, Electronics, Bedding, Furniture, Kitchen and Bath Fixtures and much more!

**visit:**  
[bestvalue.brandsource.com](http://bestvalue.brandsource.com)  
for store locations and  
special offers





## what's new *metallics*



“Metallics add excitement without an overhaul. It's the perfect accessory to a neutral space, a glimmer that won't break the bank.”

designer JOHN LOECKE

**1. HAMMERED ELEGANCE** Inspired by feng shui principles, these clean lines harmoniously contrast with hammered bases. **Sense27 Faucet in Charcoal**, starting at \$1,109, Watermark Designs, 800/842-7277, watermark-designs.com. **2. PRETTY PENNIES** Mod-inspired mosaic tile gets a modern kick in a stainless-steel finish. **Brushed stainless-steel penny rounds**, \$30 per square foot, uninstalled, Nemo Tile, 800/636-6845, nemotile.com. **3. METALLIC SPLASH** Pull out a brush and give an accent wall a guilty glimmer of copper, silver, or gold. **Benjamin Moore Studio Finish Metallic Glaze paint**, \$14.99/quart, Benjamin Moore, 888/236-6667, benjaminmoore.com. **4. GLEAMING SURFACE** Dramatic flecks of gold and silver set in bold colors create a sense of movement from different angles. **Corian Metallics solid-surfacing countertop**, \$40-\$80 per square foot, installed, Corian, 800/906-7765, dupont.com. **5. COPPERY SOAK** With its hammered top and bowed ledge, this tub echoes provincial design. **Eastwood Copper Whirlpool Bath**, starting at \$12,000, Diamond Spas, 800/951-7727, diamondspas.com.

# CAPTIVATING CONTRAST

*An interior designer successfully bridges the gap between classic and contemporary in his Hollywood Hills master bath.*

*written by* KATIE STUHLER *photographer* EDMUND BARR *field editor* LAURA HULL

O

pen yet private. Light yet dark. Organic yet old Hollywood. Interior designer Ryan Brown's master bath is a study of contrasts that draws the eye and soothes the soul.

When he moved into his 1940s home in the Hollywood Hills neighborhood of Los Angeles, Ryan had two goals for the master bath: open the layout of the small, confined space and modernize it with a spa-like atmosphere that respects the home's vintage vibe.

Converting space from an unused guest bedroom gave Ryan the square footage to create the two distinct zones he craved. One area features a tub and a spacious closet; the other contains a vanity, the shower, and a private toilet compartment. The bath opens directly into the master bedroom, with no doors dividing the two rooms. "I like not having to open and close doors," Ryan says. "The way it's positioned, it feels contained, not confined."

## FAST FACTS

**LOCATION:** Los Angeles, CA  
**HOME STYLE:** 1940s bungalow  
**BATH STYLE:** Vintage

**FUN FACT:** The homeowner was a designer on season three of Bravo TV's show *Flipping Out*.

At the same time, Ryan opened the bath to the outdoors by placing a white slipper tub in front of a bow





## TAKEAWAYS

- 1 Flea market finds add to the authentic vintage look.
- 2 Instead of adding on, this bath incorporated space from an empty adjoining bedroom.
- 3 A sliding door to the toilet compartment creates privacy.
- 4 A wide trough-style sink is an innovative alternative to a dual-sink vanity.

window overlooking a canyon, allowing view-filled soaks. “The outside is really able to come in, and you don’t feel like you have to close off space for privacy,” he says. “Having all this greenery around really adds to the organic nature of the space.”

The neutral colors and textures throughout the room echo those found in nature. Grass-cloth wallcovering with soft tones of cream, brown, and green; dark wood trim; and woven bamboo shades are pleasing counterpoints to the smooth white tub and crisp molding. Underfoot, brown hexagonal limestone tile stays true to the home’s 1940s roots and is framed by a contrasting border. “I like a lot of contrast,” Ryan says. “When used in the right way, it adds a layer of depth and character.”

Similar neutral hues color the furniturelike vanity. The black wood base rests on legs for an airy, freestanding look. Its limestone top features a trough sink wide enough for two faucets. Above the sink, an ornate black mirror adds elegance. “The vanity area rides the line of classic and contemporary,” he says. “The top is more contemporary, and the furniture piece is Hollywood Regency style.”

Across from the vanity, a 4×6-foot shower provides ample space for relaxing. The shower’s glass panels admit sunlight and show off the tiled walls.

After a long day of work, Ryan heads to his luxurious master bath to unwind. “I don’t feel like I’m in a bathroom,” he says. “I feel like I’m in an amazing hotel spa.” **KBI**

RESOURCES BEGIN ON PAGE 132.

**OPPOSITE:** Ryan chose this freestanding slipper tub to make a dramatic statement. “The lines mimic the shape of the bow window,” he says. “It’s more sculptural.”

**CLOCKWISE FROM ABOVE:** Amenities abound in the glass-lined shower, including a handheld wand, a showerhead that produces a rainlike spray, and speakers that connect to the bath’s sound system. Classic subway tile covers the shower walls, accented by a blue-gray border. Ryan opted for a shared trough sink in lieu of two individual basins—he liked how the organic look of the sink complemented the vanity’s more traditional furniturelike base. Next to the shower, a black sliding door that matches the bathroom’s dark woodwork closes off the toilet compartment for complete privacy.

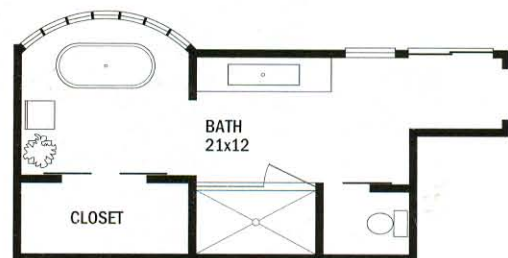



“  
I feel like I'm in an  
amazing hotel spa.”

homeowner RYAN BROWN





### 104–109 Built to Suit

**Architects**—Sabrina Weisberger Foulke, AIA, J. Richard Staub, AIA, Point One Architects, 860/434-7707, [pointonearchitects.com](http://pointonearchitects.com).

**Cabinetmaker**—Robert Bouley, Horizon Custom Cabinets, 757/393-9797, [horizoncustomcabinets.net](http://horizoncustomcabinets.net). **Range, vent hood, shelf, microwave**—DCS Appliances, 800/863-5394, [dcsappliances.com](http://dcsappliances.com).

**Refrigerator, refrigerator drawers**—Sub-Zero, Inc., 800/222-7820, [subzero.com](http://subzero.com). **Dishwasher**—Fisher & Paykel Appliances, Inc., 888/936-7872, [usa.fisherpaykel.com](http://usa.fisherpaykel.com).

**Cabinetry, perimeter and island**—Roberty Bouley, Horizon Custom Cabinets, 757/393-9797, [horizoncustomcabinets.net](http://horizoncustomcabinets.net).

**Hardware: cabinetry** in Classic Brass, **island** Notting Hill—The Raybern Co., 860/529-7704, [raybernco.com](http://raybernco.com). **Countertops: perimeter, peninsula** soapstone—Vermont Soapstone, 802/263-5404, [vermontsoapstone.com](http://vermontsoapstone.com); **island** granite in Imperial Azul—Surfaces in Stone, 866/317-8663, [surfacesinstone.com](http://surfacesinstone.com). **Faucets** Vinnata—Kohler Co., 800/456-4537, [us.kohler.com](http://us.kohler.com). **Ceiling** patterned tin—check with a local supplier.

**Paint: cabinetry and trim** Woodland Snow in semigloss—Benjamin Moore, 888/236-6667, [benjaminmoore.com](http://benjaminmoore.com) [P]; **walls** Belvedere Cream in eggshell—The Sherwin-Williams Co., 800/474-3794, [sherwin-williams.com](http://sherwin-williams.com) [P]. **Lighting: mini pendants**—Connecticut Lighting Centers, 860/249-7631, [ctlighting.com](http://ctlighting.com). **Stained glass**—Studio K's Glass Castle, 860/749-9010, [studioksglasscastle.com](http://studioksglasscastle.com). **Chairs**—Denise A. Tuite Custom Furnishings, 212/751-7470, [chairsandtables.net](http://chairsandtables.net). **Flooring** ceramic slate—Standard Tile, 860/649-8222, [tileamerica.com](http://tileamerica.com).



### 110–115 Simply Elegant

**Kitchen designer**—Kristin Okeley, ASID, CKD, Kitchens by Design, 317/815-8880, [kitchensbydesign.net](http://kitchensbydesign.net). **Builder/contractor**—Ronald J. Frazee, Ronald J. Frazee Designer & Builder, Inc., 317/291-9833, [rjfdb.com](http://rjfdb.com).

**Interior designer**—Terri Symons, Coach House Design, 317/714-1999, e-mail: [coachhouseint@aol.com](mailto:coachhouseint@aol.com). **Range, vent hood**—Wolf Appliance, Inc., 800/332-9513, [wolfappliance.com](http://wolfappliance.com). **Refrigerator, refrigerator drawers, wine cooler**—Sub-Zero, Inc., 800/222-7820, [subzero.com](http://subzero.com).

**Dishwasher**—KitchenAid, 800/422-1230, [kitchenaid.com](http://kitchenaid.com). **Warming drawer**—Dacor, 800/793-0093, [dacor.com](http://dacor.com). **Microwave**—Sharp Electronics Corp., 800/237-4277, [sharpusa.com](http://sharpusa.com).

**Cabinetry**—Downsview Kitchens, 905/677-9354, [downsviewkitchens.com](http://downsviewkitchens.com). **Cabinetry hardware**—Top Knobs USA, Inc., 800/499-9095, [topknobsusa.com](http://topknobsusa.com).

**Countertops: backsplash, perimeter**—Santarossa Mosaic & Tile Co., Inc., 317/632-9494, [santarossa.com](http://santarossa.com); **island**—Kitchens by Design, 317/815-8880, [kitchensbydesign.net](http://kitchensbydesign.net). **Flooring** custom—Ronald J. Frazee Designer & Builder, Inc., 317/291-9833, [rjfdb.com](http://rjfdb.com).



### 116–119 Captivating Contrast

**Interior designer**—Ryan Brown, Brown Design, Inc., 323/962-2600, [browndesigninc.com](http://browndesigninc.com). **Tub** Piedmont, **fixtures** in polished nickel—Sunrise Specialty, 800/444-4280, [sunrisespecialty.com](http://sunrisespecialty.com). **Shower and sink fixtures** in polished nickel—Newport Brass, a division of Brasstech, 949/417-5207, [brasstech.com](http://brasstech.com). **Sink**—Wet Style, 866/842-1367, [wetstyle.ca.com](http://wetstyle.ca.com). **Toilet** Lloyd—Toto USA, Inc., 800/350-8686, [totousa.com](http://totousa.com). **Vanity, doors, blinds, draperies**—Brown Design, Inc., 323/962-2600, [browndesigninc.com](http://browndesigninc.com). **Countertops** limestone in Mist, **shower walls and ceiling** Capriccio in Dove, **flooring** limestone in Hexagon Mist, **flooring border** limestone in Topo Azul—Ann Sacks, 800/278-8453, [annsacks.com](http://annsacks.com). **Scences** Boston Head Lights in bronze with white glass—Ryan Brown Style, 323/962-2601, [ryanbrownstyle.com](http://ryanbrownstyle.com). **Chandelier, ottoman, stool, mirror** vintage—check with local antiques dealers. **Wallcovering**—F. Schumacher & Co., 800/332-3384, [fschumacher.com](http://fschumacher.com) [T]. **Windows**—Taylor Brothers Architectural Products, 323/805-0200, [taybros.com](http://taybros.com).