

THE ORIGINAL
RESTORATION
MAGAZINE

EXTERIOR PAINT COLOR TIPS

OLD HOUSE JOURNAL

HOW TO
.....
DECOUPAGE A DRESSER
USE A SALVAGED MANTEL
BOND TO OLD CONCRETE
GET RID OF BATS

RETRO BATHS OF THE FORTIES

arts & crafts BUNGALOW

BRINGING ROYCROFT INSPIRATION
TO A 1921 HOUSE RESTORED

Wood Repair with Epoxies

+ new KITCHEN for a Prairie house

PLEASE RECYCLE THIS MAGAZINE
FEBRUARY 2019

\$7.99US \$8.99CAN



Display until February 12, 2019



HIGHLIGHTS Warm color and strong texture define the new Prairie Arts & Crafts kitchen. ■ The historic art-glass windows remain unchanged, and their square motif became a decorative element that repeats in new work. Other details come from the original house or Prairie School precedent. ■ Light fixtures were custom-made to complement the original architect-designed fixtures still in the house. ■ Although small bedrooms were combined, walls stayed in place. A few partitions were added to create privacy alcoves for the water closet and custom shower. ■ The large porcelain soaking tub all but defines baths of this era. ■ Stone plinths keep wood casings away from tile floors for easy cleaning.

DAVID HEIDE DESIGN STUDIO, MINNEAPOLIS: DHDSTUDIO.COM

the house, is a look we've always liked.

An improvement that exceeded our expectations is the addition of two Solatubes, disguised behind a wood and glass frame designed by DHD Studio. Now natural light floods the upper hall, stairway, and entry hall.

We really enjoyed the give-and-take with the Heide team. A previous Heide kitchen that we'd fallen in love with inspired our kitchen's slate-mosaic flooring, granite countertops, and red birch cabinets and trim. The Studio was helpful as we chose final hardware and paint colors. Our general contractor Tim Lemke was outstanding, not only providing high-quality work by his team and subcontractors, but also helping us identify where we could manage costs without compromising integrity.

FOR RESOURCES, SEE PAGE 103.

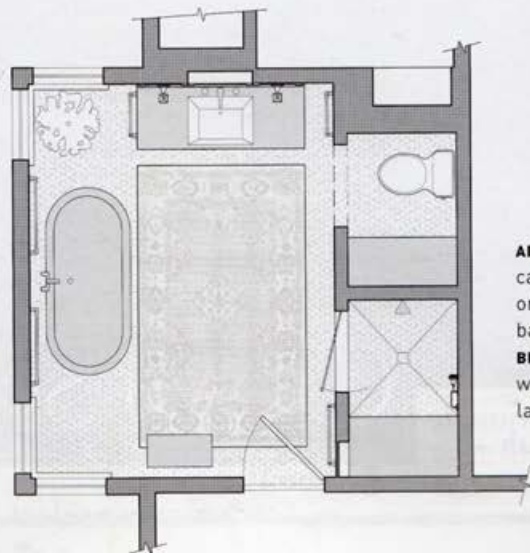

ABOVE In the master bath, the sink-cabinet doors repeat a detail seen in original windows. **LEFT** The master bath is nicely partitioned for privacy. **BEFORE** Five tiny bedrooms upstairs were reconfigured to allow for larger bedrooms and two baths.

SUCCESS!

LIGHT FIXTURES
designer **David Heide Design Studio** dhdstudio.com • fabricator **Lightworks** lightworkslighting.com

KITCHEN FLOOR
2x4 Anatolia Slate Mosaic
Minnesota Tile & Stone mstile.com

BACKSPLASH TILE
2x6 Revival tile in 'Antler Brown' **Mission Tile West** missiontilewest.com through **Fantasia**, Minneapolis; fantasiatileandstone.com

COUNTERS
White Spring granite in satin finish with 1/8" eased edge **Innovative Surfaces** innovativesurfaces.com

CABINETMAKER
JC Cabinets, Lakeville, MN; jccabinetsmn.com

HARDWARE
1 1/2" glass knobs US15 satin nickel **Emtek** emtek.com • handles 538-15 satin nickel **Schaub & Co.** schaubandcompany.com

BATHTUB
'Parisian 3' **MTI Baths** mtibaths.com through **Ferguson Showrooms** fergusonshowrooms.com

BATH FLOOR
1x1 unglazed mosaic hex tile in Bisquit **Daltile** daltile.com

SUBWAY TILE
3x6 tile in matte Designer White **American Olean** americanolean.com

EXTERIOR PAINT SCHEMES

PAINT-COLOR CONSULTANTS
Barbara Pierce, CJ Hurley **Century Arts** cjhurley.com
Design, restoration, interior/exterior color consultations; also unique fine and decorative art

Bob Buckter, Color Consultant drcolor.com Bay Area consultant also exterior schemes; detail, specializing in historic homes

Darby Samargo, The Color People colorpeople.com architectural color advisor and painter; taught to color suburbs and master homes, Martin

Emily Lauberbach Design & Color Consultation emilysdesign.com Architectural color consultation
John Crosby Freeman, The Color Doctor colordoctor.com Home/Oldhouse Color Doctor &

exterior color consultations on site or remote; also group rates for neighborhood associations

Ken Roginski, The Old House Guy oldhouseguy.com In-person & virtual paint-color consultation
Robert Schweitzer, Historic House Colors historichousecolors.com Architectural color choices & placement mapping nationwide

KITCHEN + BATH DESIGNER
Joanne Palmisano joanepalmisano.com

THEY STILL MAKE
For the clock shown:
E. Jacobsen Furniture Maker ejfm.com Woodworking & carving
Valdemar Skov skovwoodcarvingengraving.com Engraved clock dial
David Lindow, Lindow Clock Works lindowmachineworks.com Clock movement

Related Resources
Stickley stickley.com The Classics Mahogany Collection features exclusive 18th-century American reproductions in Hepplewhite, Sheraton, Chippendale & Phyle styles
Andersen & Stauffer andersenandstauffer.com High-quality handmade classical furniture reproductions

STUFF A TODDLER ... PERIOD WALLPAPER
J.R. Burrows burrows.com 'Chrysanthemum' is a ca. 1890 English-design paper derived from Morris designs; currently sold in white figure on sage-ochre ground (document colorway) and off-white figure on rose ground. Many more English & American papers offered

ST. BENEDICT PAINT
Mahogany on wood trim **Farrow & Ball** see below
FLOOR TILES salvaged, see enosticsa.at **Tile Source** tile-source.com
LINDUSTA embossed wallcovering avail. from **Wallpaper Direct** wallpaperdirect.com
p. 68 **WALLPAPER** Zuber see below
p. 68 **BRASS BEDS** Charles P. Rogers see below
p. 68 **WOODWORK** Steven Arment see below
p. 68 **PAINT** Olive CA162 (body), Leather CA 066 (trim) **Rodda Paint** roddapaint.com • **Roycroft Copper Red SW 2839** (sash) **Sherwin-Williams** sherwin-williams.com
INTERIOR PAINT
Arts & Crafts palette **Ruskin Room Green SW 0042 (DR, LR)** • **Roycroft Copper Red SW 2839** (kit) • **Studio Blue Green SW 0047 (MBR)** • **Hubbard Squash SW 0044** (hall), all Arts & Crafts. Colors from Preservation Palette **Sherwin-Williams** sherwin-williams.com

p. 68 **PAPER** 'Children's Garden' **Bradbury & Bradbury Art Wallpapers** (U.S.) bradbury.com
PAPER 'Willow Boughs', **Morris & Co.** stylelibrary.com or from **Wallpaper Direct** wallpaperdirect.com See also 'Walden' **Bradbury & Bradbury** bradbury.com
RANGE (not shown) **AGA** agamaryel.com

ENGLISH COUNTRY FABRICS & WALLPAPERS
Colefax & Fowler cofax.com
Cowtan & Tout cowtan.com
Farrow & Ball us.farrow-ball.com
Kravel, also **Brunschwig & Fils** and **Lee Jofa** kravel.com
Liberty of London libertylondon.com
Sanderson, also **Morris & Co.**, etc. stylelibrary.com
Waits of Westminster waits1874.co.uk
Zuber zuber.fr
PAINT COLORS
Farrow & Ball us.farrow-ball.com
Fine Paints of Europe finepaintsofeurope.com

Related Resources
WALLPAPER (U.S.)
Designer Classics Wallpaper designerclassicswallpaper.com Document designs; hand screened
Wallpaper Direct wallpaperdirect.com /us British & European wallpaper collections
Trustworth Studios trustworth.com English Arts & Crafts designs, digitally sized & printed, specializing in designs by GFA Voysey
BRASS BEDS
Charles P. Rogers [charlesprogers.com Classic beds, mattresses & bedding, est. 1855](http://charlesprogers.com)

SIMPLICITY DEFINED
EXTERIOR PAINT
Olive CA162 (body), **Leather CA 066** (trim) **Rodda Paint** roddapaint.com • **Roycroft Copper Red SW 2839** (sash) **Sherwin-Williams** sherwin-williams.com
INTERIOR PAINT
Arts & Crafts palette **Ruskin Room Green SW 0042 (DR, LR)** • **Roycroft Copper Red SW 2839** (kit) • **Studio Blue Green SW 0047 (MBR)** • **Hubbard Squash SW 0044** (hall), all Arts & Crafts. Colors from Preservation Palette **Sherwin-Williams** sherwin-williams.com

ROYCROFT COPPER
Copper Shop Gallery roycroftcampuscorporation.com
KITCHEN LIGHTING
Rejuvenation rejuvenation.com
WOODBLOCK PRINTS
Yoshiko Yamamoto, **The Arts & Crafts Press** artsandcraftspress.com
Kathleen West, through **The Mission Motif** missionmotif.com
CURTAINS, RUNNER
Dianne Ayres, Arts & Crafts Period Textiles textilestudio.com
BASKET
Lestae Burt, Handwoven Arts handwovenarts.com
GARDEN SCULPTURE
'Sprite' by **Alfonso Lanelli** for **Frank Lloyd Wright, Midway Gardens, Chicago**; reproduced under license to **FLW Fdn.** by **Nichols Bros. Stoneworks**, Snohomish, WA; nicholsbros.com

Related Resources
ROYCROFT
Dard Hunter dardhunter.com Grandson of the Roycroft designer; purveyor of Arts & Crafts tile, framed prints, servingware, small furnishings & more
Laura Wilder laurawilder.com Nature-inspired block prints & paintings by a Roycroft Renaissance artist
Stickley stickley.com Re-issues of Stickley & Roycroft furniture
LIGHTING
House of Antique Hardware houseofantiquehardware.com Arts & Crafts fixtures with many options
Vintage Hardware & Lighting vintagehardware.com Reproduction A&C lighting fixtures

CARVING A FUTURE WOODWORK
Steven Arment, Woodcarver, Wallowa Valley, OR; arment.willowsgmail.com Custom woodwork, carving & furniture
PAINT ARTIST
Anna Vogel, Wallowa Valley, OR; annastreaming@gmail.com
LINOLEUM
Marmoleum by Forbo forbo.com
FINE LUMBER
Jayzee Lumber, Joseph, OR; jayzeelumber.com

Related Resources
Gingerbread Man gingerbreadman.com Fancy Victorian-era carved and turned woodwork & trim

Coming April 2019

KITCHENS & BATHS

Bright painted kitchen; the countertop question; celebrating 1940s bath design; using art tile.

ALSO: Visit two Arts & Crafts homes with Prairie School influence; Arts & Crafts interpreted for a modern kitchen; lighting of the Teens and Twenties.

SUBSCRIBE: call (800) 234-3797

